

FOR CONTINUATION REFER TO DRAWING No. H004

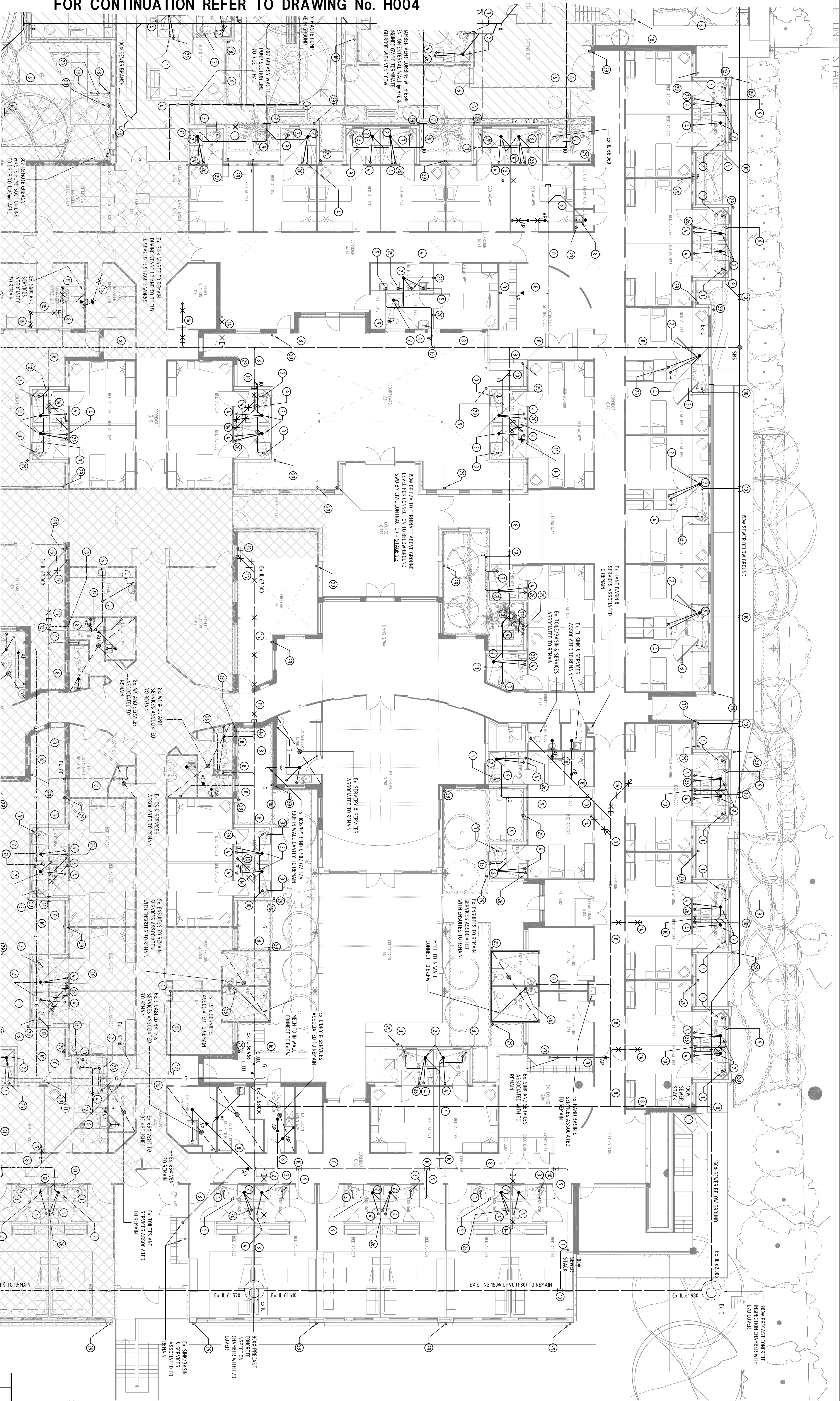

FOR CONTINUATION REFER TO DRAWING No. H006

DRAWING NOTES:

1. 1000 SEWER STACK P/A 1/8
2. 1000 PWD/SHOWER OUTLET
3. 1000 WC WASTE 1/8 C/W 1000x90° BEND
4. 1000 P/W FROM BASIN/HAR BASIN 1/8
5. 1000 SINK WASTE 1/8 C/W 1000x90° BEND
6. 1000 SEWERS BELOW GROUND IN 1500 FALL
7. 1000 SEWER BRANCH
8. EX. SEWER TO REMAIN (APPROX. LOCATION)
9. 1000 SEWER BELOW FLOOR SLAB IN 1500 FALL
10. CONNECTED IN TO EX. SEWER
11. 1000 SEWER BELOW FLOOR SLAB IN 1500 FALL
12. CONNECTED IN TO EX. SEWER
13. 600 DRAINAGE VENT TO ABOVE ROOF LEVEL WITH VENT COIL
14. EX. SEWER
15. EX. SEWER (APPROX. LOCATION) TO REMAIN DURING STAGE 1, 2 & 3, TO BE ABOLISHED AND CUT & SEALED AND MADE REDUNDANT DURING STAGE 3 WORKS
16. EX. GREASY DRAIN TO REMAIN (APPROX. LOCATION), ALLOW TO REMAIN AND MAKE GOOD OF THESE DRAINS ARE AFFECTED BY DIRECTION OF SEWERS IN DISPOSITS
17. 800 GREASY WASTE FRONT PIPE SECTION INLET WITH CAMLOCK COUPLING WITH 800 SOLUTION VALVE @ 1200mm AFL
18. 1000x75 COILOR BEND DP F/A TO TERMINATE ABOVE GROUND LEVEL FOR CONNECTION TO BELOW GROUND SMD BY CIVIL CONTRACTOR
19. 1000x75 COILOR BEND DP F/A TO OFFSET @ H/L OF GROUND FLOOR
20. 1000 SMD @ H/L OF GROUND FLOOR
21. 500 SMD TAPPED TO TO R/DZ
22. 1000 GREASY STACK P/A 1/8
23. 500 TRAPPED WASTE TO DISHWASHER C/W 1000x90° BEND
24. 500 TAPPED TO TO BAIN MAKE
25. 500 TRAPPED WASTE TO WAREHOUSE C/W LONG RADIUS BEND
26. 500 H/L TO IN WALL WITH ACCESSIBLE PANEL UNDER HAND BASIN @ 300mm AFL, DISCHARGE TO SHOWER P/W
27. 500 H/L TO UNDER BENCH & CONNECTED TO SINK TRAP ABOVE WATER SEAL
28. 500 TRAPPED WAREHOUSE WASTE
29. 1000 DP F/A TO TERMINATE ABOVE GROUND LEVEL FOR CONNECTION TO BELOW GROUND SMD BY CIVIL CONTRACTOR - STAGE 2, 3
30. DRG

STAGE 1 WORK

STAGE 3 WORK

KEY PLAN

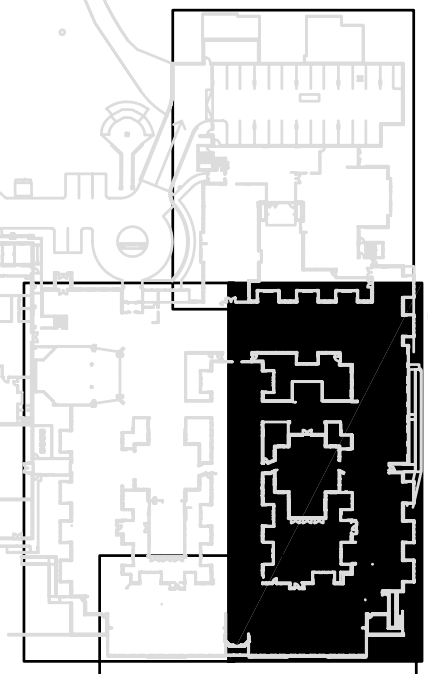

<div><div>PLUMBCO</div><div>PLUMBERS</div></div>										A.B.N. 91 097 899 238 PLUMBCO PLUMBERS PTY LTD PO BOX 298 PORT MELBOURNE VIC 3207 email: info@plumbers.com.au		U.P. 35542 PHONE: 9846 7330 FAX: 9846 1827 email: info@plumbers.com.au					
PROJECT										SAINT FRANCIS OF ASSISI		220 ROSANNA ROAD		ROSANNA		TITLE	
HYDRAULIC SERVICES										SEWER AND STORMWATER LAYOUT		GROUND FLOOR - STAGE 2					
DATE		27.11.12		DRAWN		AT		CS		CHECKED		SCALE		B1 = 1:100			
JOB NO		P-12-005		DRAWING No		H005				REV		B					
No		DATE		REVISED						BY		PM		AT			
B		20.09.13		AS INSTALLED - STAGE 2 WORKS													
B		27.11.12		AS INSTALLED													